

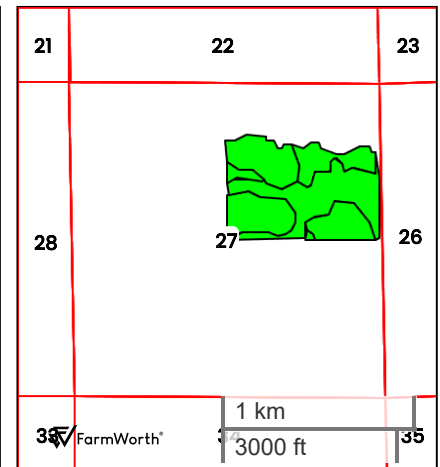

DAVIS JUNCTION FARM (100.07 AC TOTAL, 93.49 AC TILLABLE)

TILLABLE SOILS

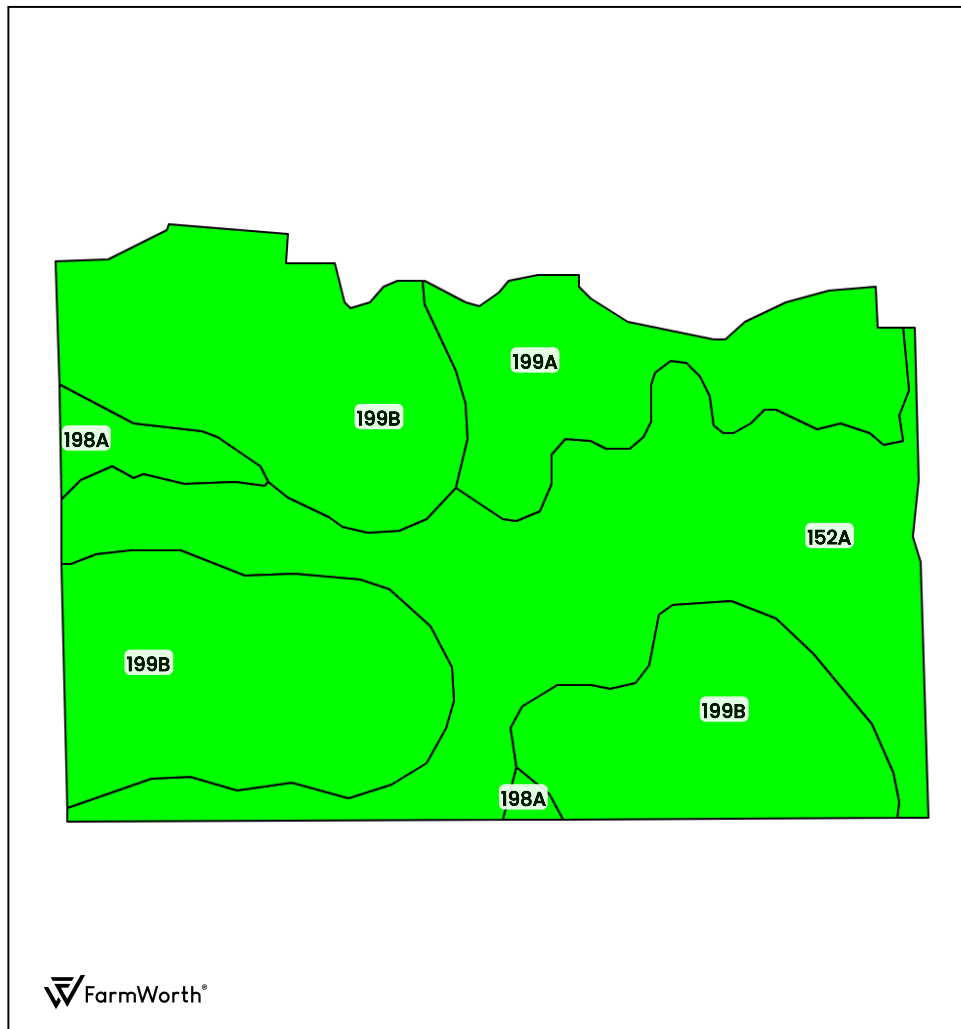

County: **Ogle County, IL**
Location: **27-42N-1E**
Township: **Scott**
Acres: **93.49**
Date: **09/19/2025**



Field borders obtained from Farm Service Agency
as of 2008

FarmWorth, LLC makes no representations or warranties, express or implied, as to the accuracy of any information, data, numerical values, boundaries, or any other information generated through the use of FarmWorth.com. User is solely responsible for independently investigating and determining all information provided through FarmWorth.com prior to use and waives any and all claims against FarmWorth, LLC for any inaccuracies or inconsistencies in the information and/or data.

Code		Description	Acres	% of field	IL PI	Drainage Class
199B		Plano silt loam, 2 to 5 percent slopes	45.25	48.40 %	141	Well drained
152A		Drummer silty clay loam, 0 to 2 percent slopes	33.24	35.55 %	144	Poorly drained
199A		Plano silt loam, 0 to 2 percent slopes	12.35	13.21 %	142	Well drained
198A		Elburn silt loam, 0 to 2 percent slopes	2.65	2.83 %	143	Somewhat poorly drained
Average:					142.3	

IL Productivity Index calculations are based on Bulletin 811 and obtained from the [NRCS Field Office Technical Guide](#)
Soils data provided by USDA and NRCS.